

EB-200 Armature Plate

Armature Plate for Secure Out-Swing Door Installations

The EB-200 Armature Plates are designed for use with the XL-200 Armature Plate Housing, providing an efficient, secure solution for 90° out-swing doors.

These plates feature a special hardening treatment for enhanced durability and are engineered for easy installation, saving both time and effort.

Key Feature

Elegant Design:	Crafted with attention to detail, offering an attractive, sleek appearance while maintaining high functionality.
Effortless Installation:	Designed for quick and easy installation without the need for drilling through the door, reducing the installation time and complexity.
Concealed Fasteners for Enhanced Security:	The sexnut bolt is concealed inside the housing, preventing it from being exposed externally and enhancing security.
Durability:	Special hardening treatment increases the longevity of the armature plates, making them suitable for high-traffic environments.



Magnetic Lock Installations:

Designed to be used with the XL-200 magnetic lock armature plate housing for securing 90° out-swing doors in various settings.

Commercial Doors:

Ideal for use in office buildings, retail spaces, and public institutions where secure, easy-to-install door hardware is required.

High-Security Areas:

Suitable for use in high-security environments such as banks, data centers, and secure government facilities, where concealed fasteners are essential for enhanced security.

Residential Doors:

Can be used in residential homes for out-swing doors that require durable and secure locking systems, particularly for entrance or patio doors.

Access Control Systems:

Perfect for integration with electronic access control systems, providing a secure and durable solution for frameless and swing doors.

Installation

Install Method 1

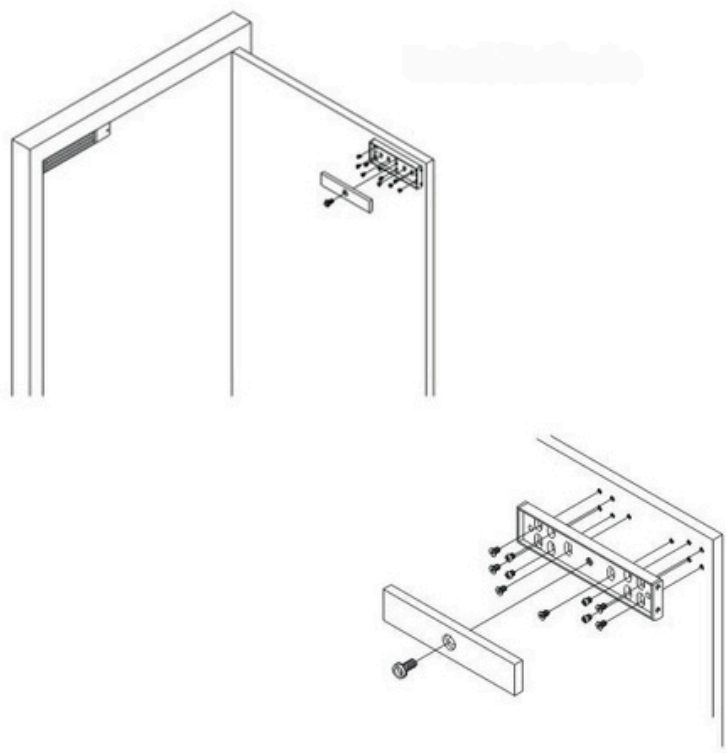

Install Method 2

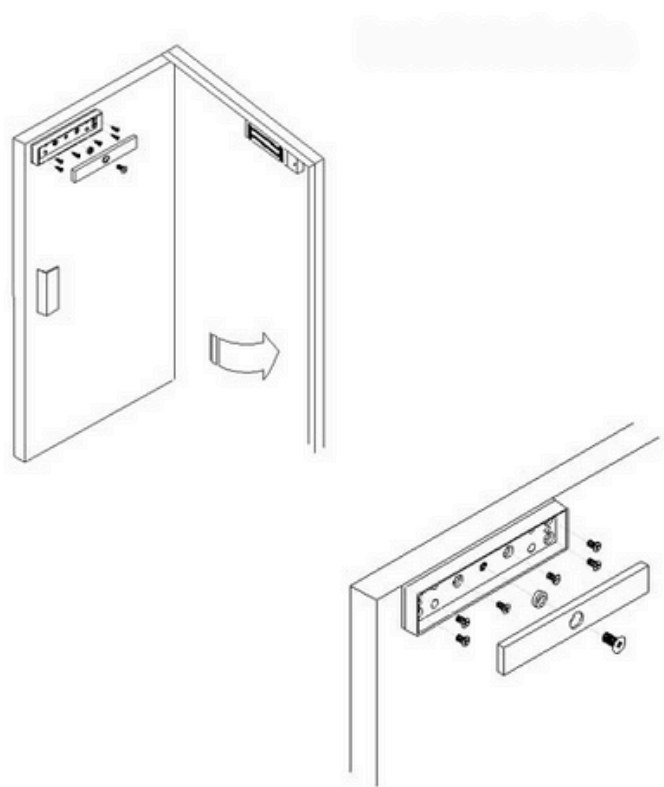

Application:

- Office Entrances: Ideal for use in office buildings, securing out-swing glass or wooden doors, ensuring both safety and durability.
- Retail Storefronts: Suitable for retail store entrances, providing an elegant and secure locking mechanism for frameless or standard out-swing doors.
- Hospitality Industry: Used in hotels, restaurants, and resorts for securing entrances and interior glass doors, maintaining aesthetics while enhancing security.

Specification:

Model Number:	EB-200
Material:	Hardened for increased durability and reliability.
Compatibility:	Suitable for all types of 90° out-swing doors.
Dimensions:	193 x 45 x 12.7 mm